

# data sheet

**Colenta<sup>®</sup>**

## **FILM Processor** **20 C41 25 SST Eco**



**Colenta<sup>®</sup>**

C41 Processor options for sheet and roll film  
up to 20cm in width

09/2016 AN



# C41 Film Processor

TYPE:COLENTA 20 C41 25 SST Eco

## Technical Specifications:

<b>Processing applications:</b>	C41 Negative film
<b>Max. Process width:</b>	<b>max. 20 cm - 8 inch</b> (3 Track loading of 35mm film)
<b>Microprocessor Control:</b>	with 4 preprogrammable processing cycles
<b>Processing capacity:</b>	<b>25 cm per minute @ 3 min 15 sec Dev.Time</b> (Dev. times are pre-programmable)



Microprocessor  
controlled Display

## **Tank capacities: 20 C41 25 SST Eco**

<b>Developer</b>	:	<b>12,5</b>
<b>Bleach</b>	:	<b>6,0</b>
<b>FIX</b>	:	<b>6,0</b>
<b>FIX</b>	:	<b>6,0</b>
<b>STAB</b>	:	<b>6,0</b>
<b>STAB</b>	:	<b>6,5</b>

<b>Replenishment:</b>	<ul style="list-style-type: none"><li>- Precisely controlled using opto-sensors to measure the film area loading.</li><li>- Activated after a pre-programmed film area is fed into the processor</li><li>- Antioxidation/standby replenishment, activated after 0-9 hours *</li></ul>
<b>Solution Levels:</b>	Low Level monitoring in all tanks High Level monitoring in Overflow Collection Tanks (waste management, optional) * Low Level in Repl. Tanks for Dev-, Bleach, Fix and Superstabi (optional) *
<b>Temperatures:</b>	High / Low level monitoring for all the wet-tanks incl cold water cooling
<b>Work in Progress :</b>	Details the location of film within the processor.
<b>Transport:</b>	Drive motor overload monitoring Security cover lid switch
<b>standard accessories:</b>	<ul style="list-style-type: none"><li>- rack carrier drip tray</li><li>- basic installation kit</li><li>- 3 x 35mm film loading assy</li><li>- small spare part kit</li></ul>
<b>optional accessories:</b>	<ul style="list-style-type: none"><li>- day light loading sleeves in loading box</li><li>- external chiller unit</li><li>- roll feed up and motorized take up device</li></ul>

Technical specification subject to change without notice.

**Transport System: 20 C41 25 SST Eco**

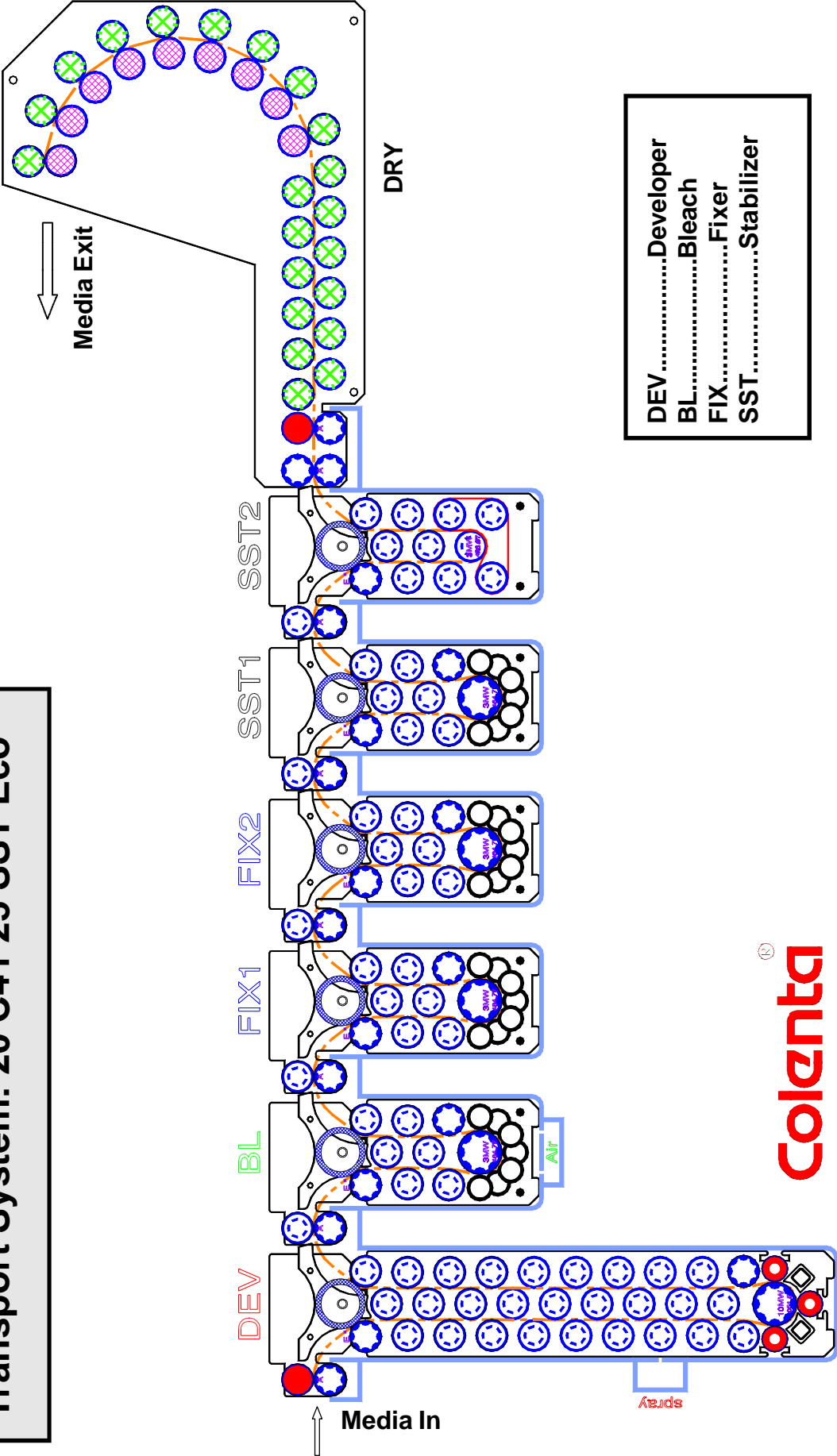

DEV.....Developer  
 BL.....Bleach  
 FIX.....Fixer  
 SST.....Stabilizer



## Dimensions: 20 C41 25 SST Eco

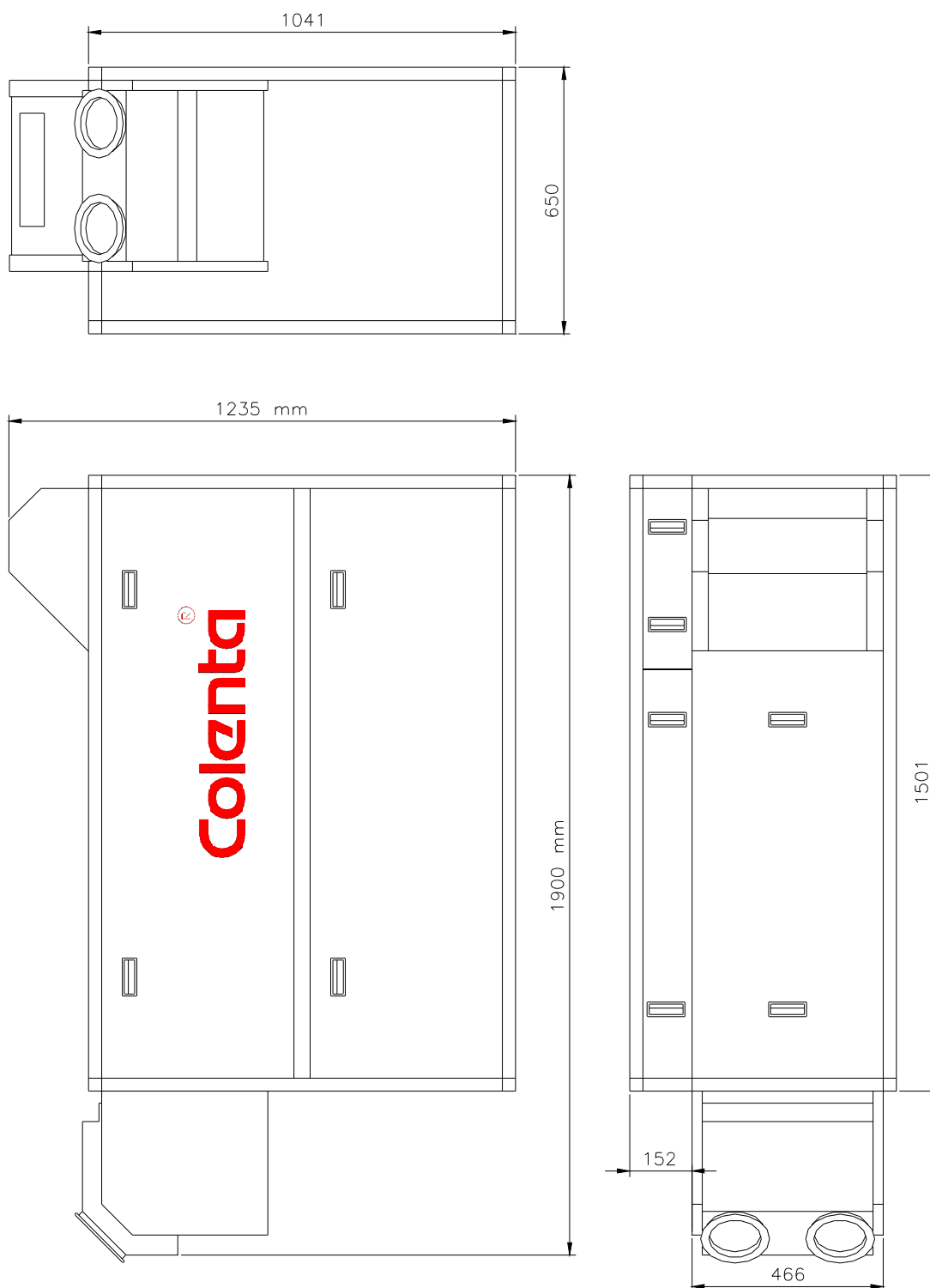

All dimensions are in mm.

We recommend a minimum walking space of 60cm around the processor.

**through the wall installation: 20 C41 25 SST Eco**

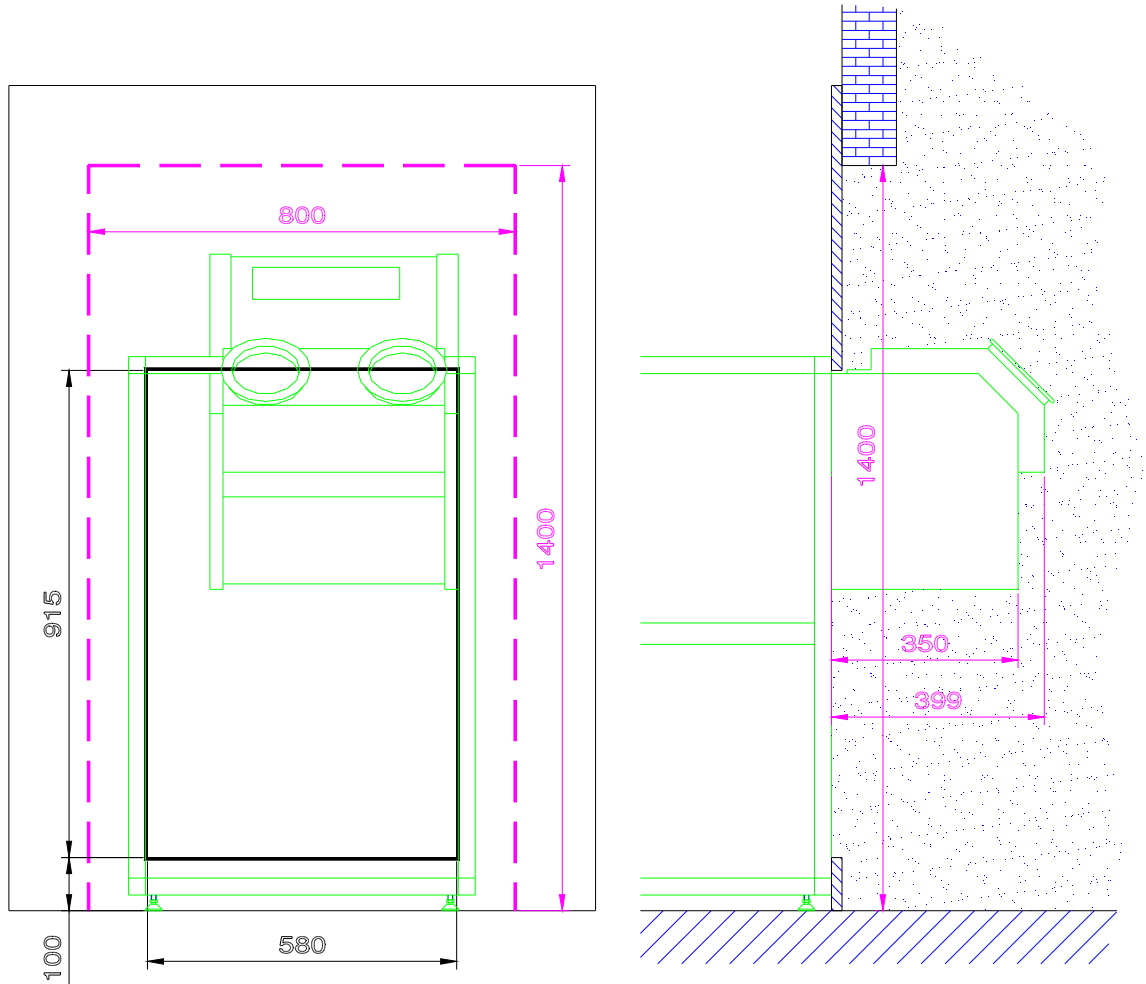

**All dimensions are in mm.**

**We recommend a minimum walking space of 60cm around the processor.**

# Electrical supply: (Standard, when 3N~400/230V, 50/60 Hz supply available)

**20 C41 25 SST Eco**

**Colenta**<sup>®</sup>

**4,8 kW**  
**13 A per phase**

ATTENTION:  
PROCESSOR TO BE CONNECTED TO  
SUPPLY NET: 3N~380/220V 50/60Hz

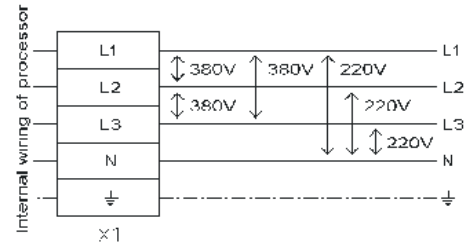

In case the above voltages are not available at site, please contact your local dealer or the factory for rewiring advice.

Alternatives, to be indicated when ordering.

## Details for shipment:

**20 C41 25 SST Eco**

packing dimensions: 1 wooden box on palette  
215cm x 95cm x 165cm (L x W x H)  
packing volume: 3,37 m<sup>3</sup>  
weight with packing: 360 kg